

Front Panel



DELETE THIS LAYER

This instruction layer is to help with setup only and should be deleted prior to printing.

Call with questions:
McGreevy ProLab & ProPress (518) 426-1039
www.mcgreevyprolab.com

FOLD

Back Panel



4¼ x 5½ Quad-Fold Card (Exterior)

Folds Vertically

Template Size: 17.25" x 5.75"
Final Trim Size: 17" x 5.5"
Folds to: 4.25" x 5.5"

FOLD

Folding Diagram



Step 1

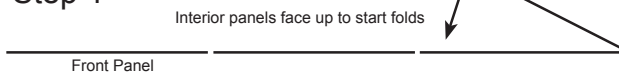

Step 2

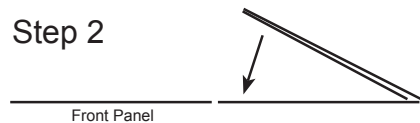

Step 3

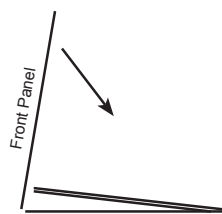

Fold-in Panel #2

FOLD

← **Trim Line 1/8" (Red Line):** Anything outside this line will be trimmed off. For full bleed printing your artwork **MUST** extend beyond this red line all the way to the outside edge.

← **Text Safty 2/8" (Green Line):** Do not place text closer to the edge than this line.

← **Border Safty 3/8" (Blue Line):** If you are using borders, they must be at least this far from the outer edge.



Fold-in Panel #1

Inside Top Panel



DELETE THIS LAYER

This instruction layer is to help with setup only and should be deleted prior to printing.

Call with questions:
McGreevy ProLab & ProPress (518) 426-1039
www.mcgreevyprolab.com

FOLD

Inside Top Center Panel



4¼ x 5½ Quad-Fold Card (Interior) Folds Vertically

Template Size: 17.25" x 5.75"
Final Trim Size: 17" x 5.5"
Folds to: 4.25" x 5.5"

FOLD

Inside Bottom Center Panel



FOLD

← **Trim Line 1/8" (Red Line):** Anything outside this line will be trimmed off. For full bleed printing your artwork **MUST** extend beyond this red line all the way to the outside edge.

← **Text Safty 2/8" (Green Line):** Do not place text closer to the edge than this line.

← **Border Safty 3/8" (Blue Line):** If you are using borders, they must be at least this far from the outer edge.



Inside Bottom Panel